

4 Install Brackets and Expanding Shelves

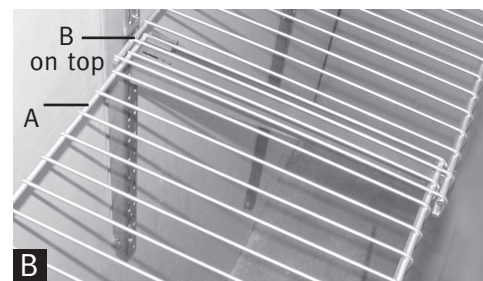

A Insert brackets into uprights at desired locations. Note: Install brackets and shelving at the top first and work down. Brackets will not fit into upper two slots of each upright.



B Overlapping shelves Shelves are fully adjustable and require no cutting. To adjust width, overlap the shelves making sure the shelf labeled "A" is placed first on the brackets and the shelf labeled "B" is placed on top of "A".



C (1) Install shelves into brackets Confirm that the bracket locks are unlocked and install shelving making sure that the "nose" of the bracket is projecting out through the front edge of the shelf. Note: For maximum weight capacity, do not insert brackets into bottom slots of upright.

►Hint: When overlapping sections of shelving, shelves labeled "A" must be placed onto brackets before shelves labeled "B".

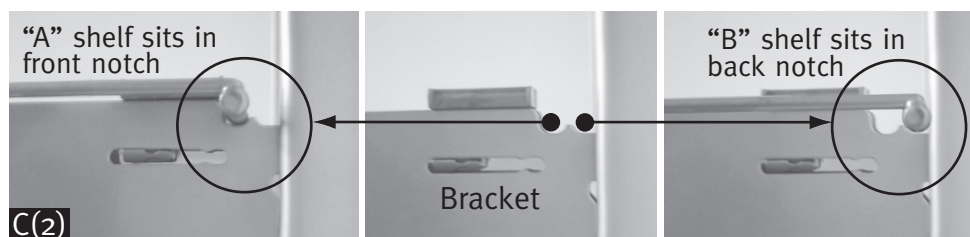

C(2) Place shelves onto brackets Shelf labeled "A" sits in front notch of bracket. Shelf labeled "B" sits in back notch. Be sure each shelf slides back as far as possible before locking shelves into brackets. If overlapping three sections of shelving, use two "A" sections and one "B" section, placing "A" sections on the outside and spanning the gap with "B" sections. For four or more overlapping sections, continue alternating between "A" and "B" sections, placing "A" shelves on brackets before "B" shelves.

►Hint: If shelves are installed in the incorrect notch, shelving weight capacity could be lessened.

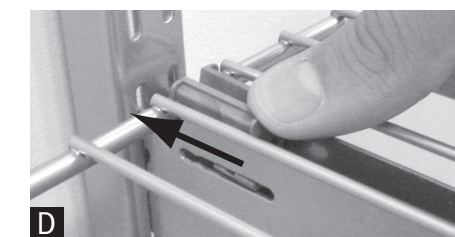

D Secure shelves with bracket locks After all shelves are positioned properly, lock shelves into brackets by sliding the plastic locking clip toward the back wall. It will "snap" into locked position.

5 Install Adjustable Clothes Rods

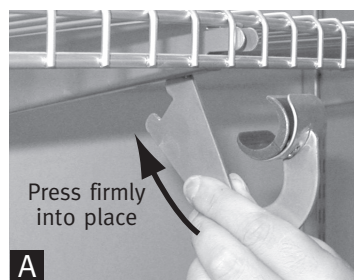

A Install rod hanger Install rod hanger into bottom of bracket by tilting it backward until it locks in place. Note: Be sure to press rod hangers firmly into place for proper installation.

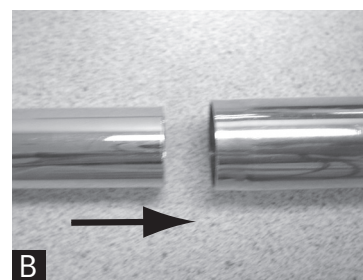

B Adjust rod length Rods can be used separately or telescoped together. 48" rods telescope up to 8' and 26" rods telescope up to 4'.

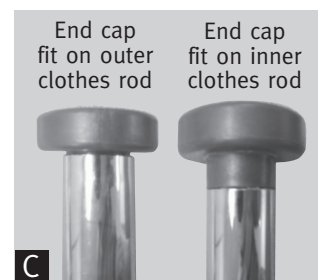

C Add end caps Place end caps on the end of each clothes rod. End caps will fit either diameter of rod (as shown above).

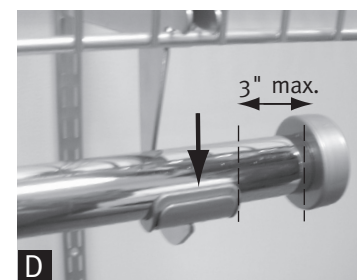

D Secure rod and hanger After expanding clothes rod to desired length, place into rod hangers and press down to snap into place. Note: Do not extend

4-8 ft. Adjustable Closet System

7Q30

Rubbermaid® homefree
SERIES™

©2015 Rubbermaid Incorporated, Huntersville, NC 28078-1807 • 1-888-895-2110
www.rubbermaid.com A *NewellRubbermaid* Brand

Tools Needed
for Installation

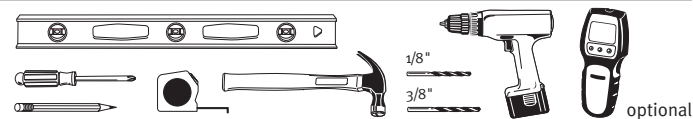

1943113/1943114

Please read through the instructions completely and check that you have all parts before beginning. Depending on the configuration you choose to install, you may not use all of the components.

Description	Part Number	Quantity	
48.25" Shelf (labeled A)	3G62	1	
48.25" Shelf (labeled B)	3J62	1	
26.25" Shelves (labeled A)	3G60	3	
26.25" Shelves (labeled B)	3J60	2	
47.5" Uprights	3G64	5	
Brackets	3G63	15	
48" Overlapping Hang Rails	3G67	2	
Clothes Rod Hangers	3G68	9	
48" Inner Clothes Rod	3G76	1	
48" Outer Clothes Rod	3G77	1	
26" Inner Clothes Rod	3G72	1	
26" Outer Clothes Rod	3G73	1	
22" Rail Covers	3J57	4	

The following parts are packed together in a hardware bag:

Screws	1603168	13	
0.5" Drywall Anchors	3J65	8	
Anchor Push Pin	3J66	1	
2" Rail Covers	3J55	2	
Clothes Rod End Caps	3G71	6	

1 Mount Overlapping Hang Rails

NOTE: hang rail MUST be mounted to studs.

The drywall anchors are not designed to provide significant support to the closet system. They are only to be used to hold the uprights vertical and to hold the end of hang rail tight against the wall when rail overhang exceeds 4" (see step D1).

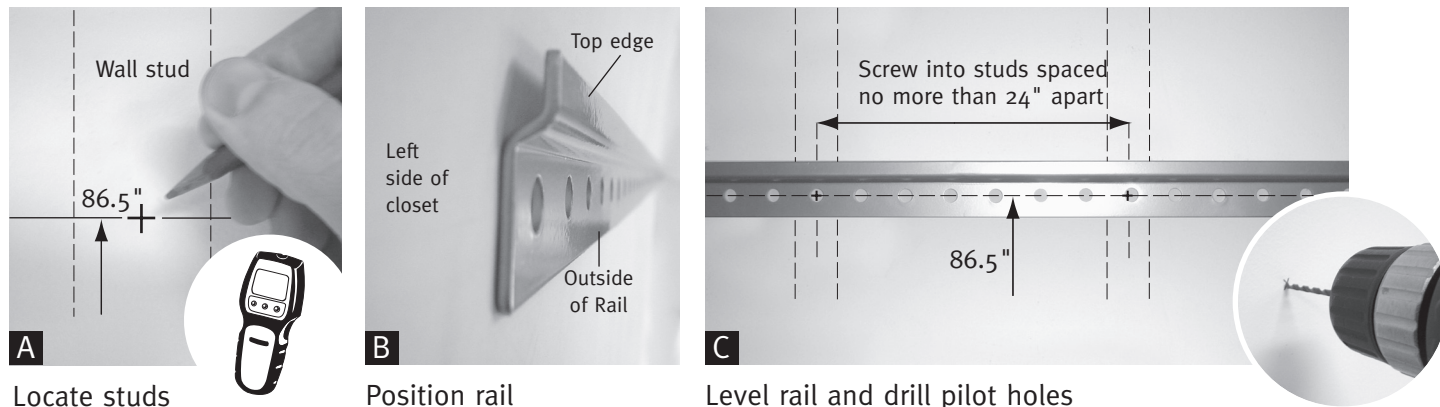

A **Locate studs**
On closet wall, locate all wall studs and mark them 86.5" above the floor. Using a stud finder can be useful (optional).

B **Position rail**
Position first hang rail so that the rail is touching the left side of your closet.

C **Level rail and drill pilot holes**
Level hang rail and mark holes 86.5" above floor that land on studs, then drill 1/8" pilot holes for screws.

►Hint: Draw a pencil line across your 86.5" mark to identify screw placement and ensure that the line is level.

Secure left end of rail - rail overhang
If there is a stud within 4" from the wall, skip steps D (1) and D (2).

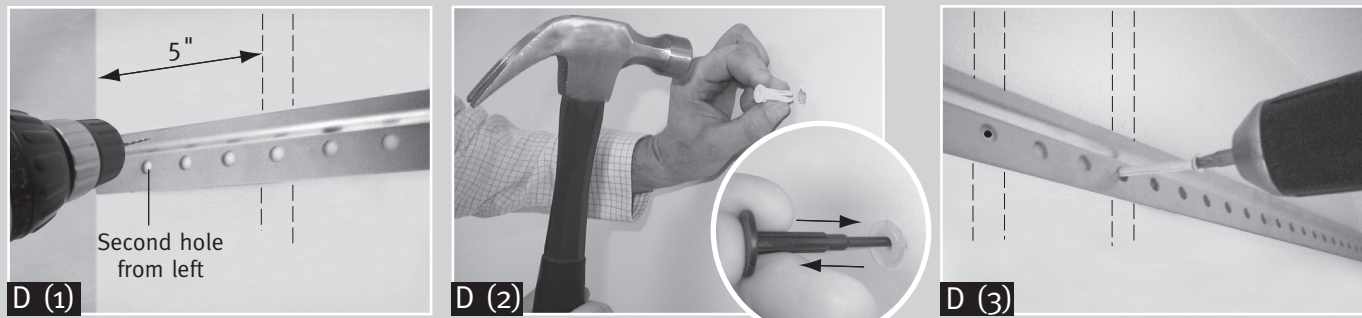

D (1) **Drywall anchor installation***
Mark and drill a 3/8" hole (for a wall anchor) in the second hang rail hole from the left. To compress the anchor, fold the sides and bend. Hammer the wall anchor flush to wall in the drilled hole. Insert anchor push pin to engage anchor, then remove.

D (3) **Rail fastening**
Starting at left side, fasten the first two screws into studs. *Do not fasten remaining screws until after next step.* Note: Screws need to be fastened through rail into each wall stud spaced no more than 24" apart.

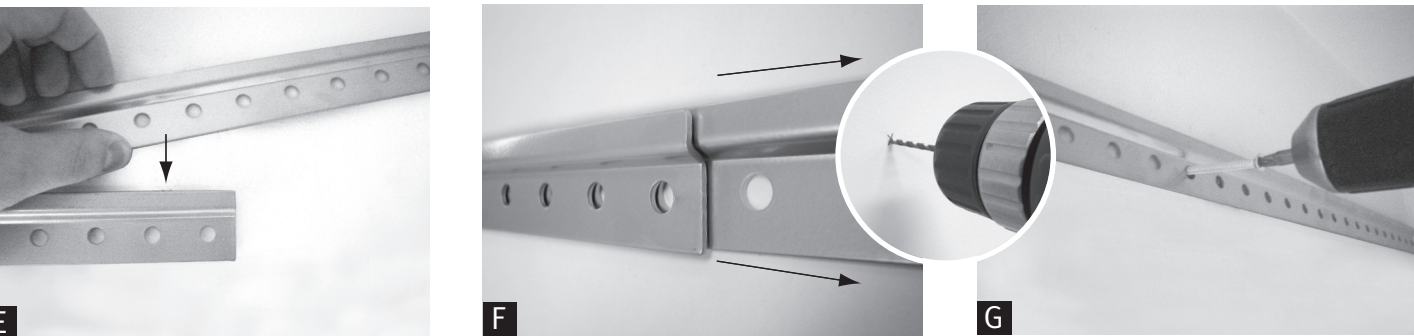

E **Position second hang rail** if closet space is wider than 4"
Slide second hang rail down behind the first from above.

F **Extend second hang rail**
Slide second hang rail as far right to the wall as possible while still maintaining hole alignment. Repeat step C to secure to the wall. If there is not a stud within 4" of the RIGHT end of the hang rail, repeat the dry wall anchor installation step above.

G **Secure second rail from right side**
Install screws into studs along rails. Secure rail in all studs.

2 Plan Your Layout

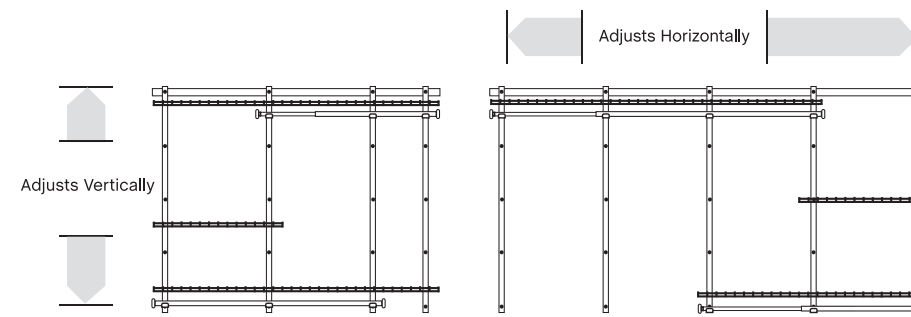

Before securing uprights, be sure to assess your storage needs. If you are using Homefree accessories, be sure to place your uprights at 22" apart and ensure drawers or sliding baskets have adequate space.

3 Hang Uprights

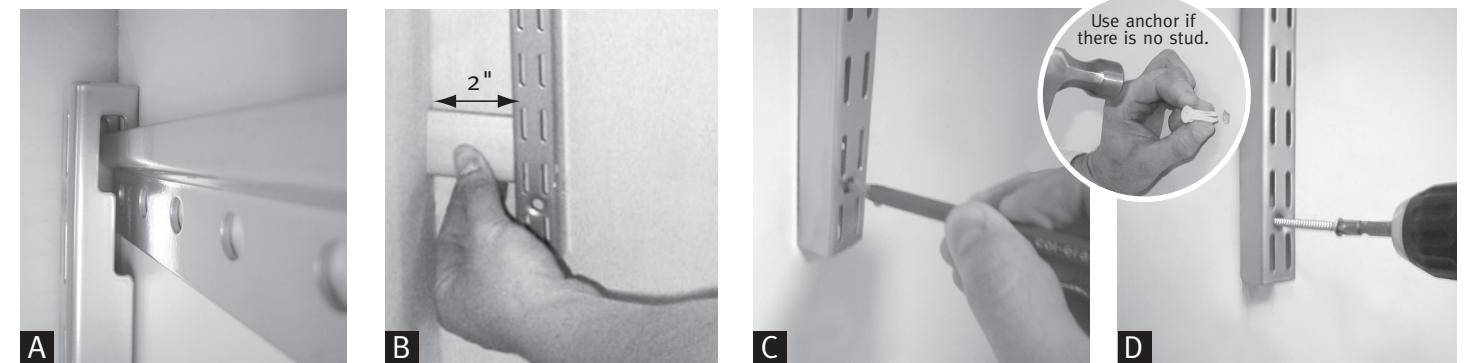

A **Hang uprights**
Hang first two 47.5" uprights over the hang rail.

B **Position at 2"**
Position both outside uprights 2" from the right and left corners by using the 2" rail cover for spacing.

C **Secure**
Mark bottom hole of each upright. Drill 1/8" pilot hole into stud. (Use wall anchor and 3/8" bit if there is no stud.)

D **Fasten at bottom**
Fasten screws into studs or wall anchors. Screws are needed only in bottom holes of uprights.

►Hint: If the left side of closet is more accessible, space the remaining uprights from left to right. If the right side of the closet is more accessible, space the remaining uprights from right to left.

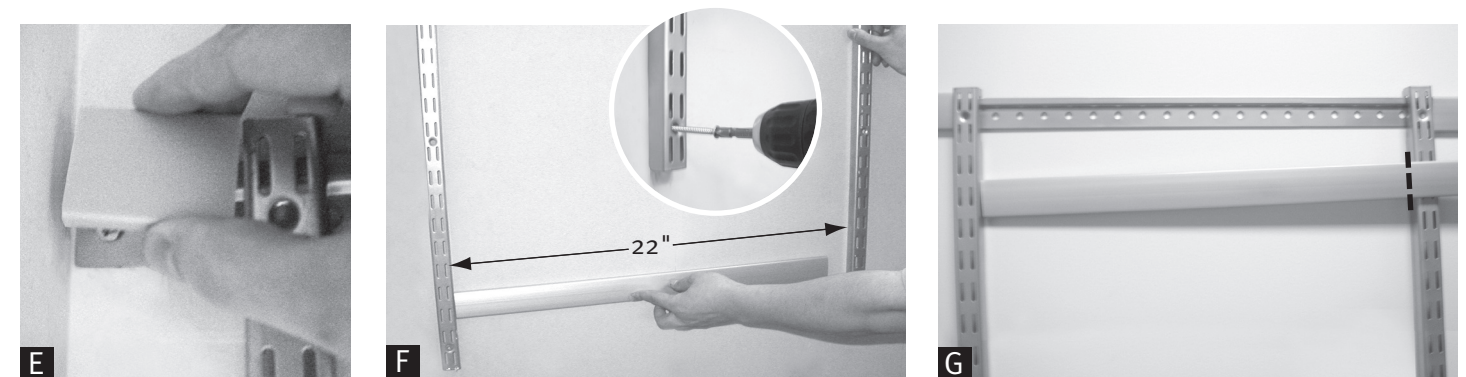

E **Attach 2" rail cover**
Clip 2" rail cover over hang rail so uprights stay in place.

F **Use 22" rail cover for spacing**
Hang another 47.5" upright on the rail and use one of the 22" rail covers to space over 22". Drill 1/8" pilot hole and fasten screws in bottom hole. (Use wall anchor and 3/8" bit if there is no stud.) Place 22" rail cover over rail between uprights. Repeat step F for additional upright (if space allows).

G **Attach 22" rail cover**
If the space between the last uprights is less than 22", you may choose to cut rail cover with scissors to fit. Note: Add-on accessories require uprights to be placed at 22" apart.

►Hint: Determine the placement of your shelves and hang rails. Start from the top and work your way down to ensure that you have enough room.